



# BREWFLEX

## A U S T R A L I A

### BPE

#### Welded Butterfly Valve

3A No.LV-E016

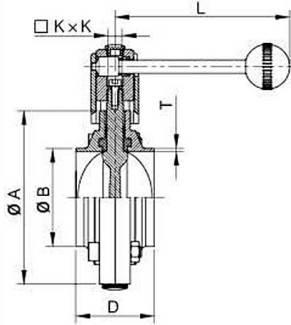

Size	A	B	KxK	L	T	304	316
3/4"	78	19.05	10x10	50	138	1.85	
1"	78	25.4	10x10	50	138	1.85	
1 1/4"	78	31.6	10x10	50	138	1.85	
1 1/2"	86	36.1	10x10	50	138	1.85	
2"	100	50.6	10x10	52	138	1.85	
2 1/2"	115	83.5	10x10	58	138	1.85	
3"	128	76.2	10x10	58	163	1.85	
4"	154	101.6	10x10	64	163	2.1	
6"	225	152.4	14x14	80	165	2.6	

#### Clamped Butterfly Valve

3A No.LV-E017

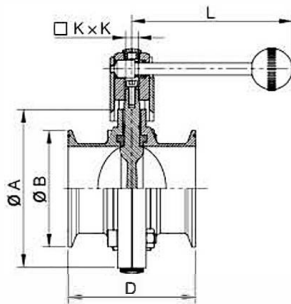

Size	A	B	KxK	D	L	04	316
3/4"	78	25.2	10x10	66	138		
1"	78	50.5	10x10	66	138		
1 1/4"	78	50.5	10x10	66	138		
1 1/2"	86	50.5	10x10	70	138		
2"	100	64	10x10	76	138		
2 1/2"	115	77.5	10x10	80	138		
3"	128	91	10x10	84	163		
4"	154	119	10x10	104	163		
6"	225	166.6	14x14	130	165		

#### Threaded Butterfly Valve

3A No.LV-E018

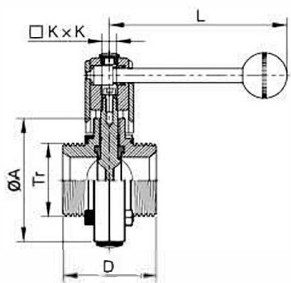

Size	A	Tr	KxK	C	L	304	316
1"	78	37.13X1/8 TACME	10x10	66	138		
1 1/2"	86	50.65X1/8 TACME	10x10	70	138		
2"	100	64.17X1/8 TACME	10x10	76	138		
2 1/2"	115	77.67X1/8 TACME	10x10	80	138		
3"	128	91.19X1/8 TACME	10x10	84	163		
4"	154	119.25X1/8 TACME	10x10	104	163		